



Transfer onto wooden panel

HOW TO sheet



In this example we are transferring on to a wooden panel.

This technique will transfer a colour OR black and white photocopied image onto most surfaces, such as stretched canvas, canvas board, masonite, MDF, fabric, metal, perspex etc.

YOU WILL NEED:

- MM4 Gel Medium
- A substrate (canvas or wooden panel.)
- Brush
- Scissors
- Selected Images (photocopy laser prints work best)
- pencil 2H
- Sponge



Cut images to chosen shapes, you can use any interesting shape; in this example we have cut circles of varying sizes.



Design the lay out of your art work and use a pencil (2H) to outline the positioning of your images. Before you start drawing this outline, take your time in deciding on an interesting composition, remembering that the image will be in.

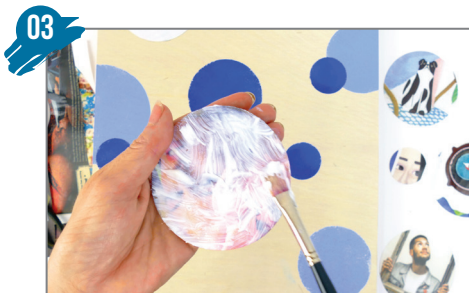

Apply a generous layer of the acrylic gel medium to the front of the image. While it is still wet, place the image face down into the position as drawn out earlier. Allow this to dry out thoroughly (overnight).



When completely dry, dampen the paper with a wet sponge. Give it a few minutes to allow the water to penetrate the paper pulp. Begin rubbing carefully to remove the paper, if you are having problems removing the pulp just add more water. This will remove the bulk of the pulp; however you will need to repeat this process until the image is easily visible.



Having removed all the bulk of the paper pulp you will find that the image appears slightly cloudy. To overcome this, varnish the image with a coat of gel medium.

Watch More



Search Derivan Matisse on You Tube

More Projects & Product Demos

DERIVAN

Derivan Pty Ltd

ABN 36 003 273 925

Unit 4/23 Leeds St. Rhodes NSW 2138

T: 02 9736 2022 F: 02 9736 3637

derivan@derivan.com.au

r05/17